

Mounting frames for plasterboard walls



Karton Fix 9.0 technical data sheet

Standard code 377319

Sommario

DESCRIPTION	3
FEATURES	3
STRUCTURE FEATURES	4
CISTERN FEATURES	4
DIMENSIONS	5
STANDARD SUPPLY	6
ON DEMAND	6
PACKAGING	6
ACCESSORIES AND SPARE PARTS	7
ELENCO	9

Karton Fix 9.0

Mounting frames for plasterboard walls

DESCRIPTION

Mounting frame for floor-standing WCs complete with 9-lt Monolith 9.0 flush-mounted cistern. Also available in 6lt version.

For plasterboard walls.

Karton Fix is the ideal solution for installations in equipped plasterboard walls: no kit required and reduced risk of error.

FEATURES

Features and plus



For floor or squat WCs



For plasterboard walls



Capacity 9 litres



Double drain with adjustable partial (2.5 to 3.5 litres)



Assembly operations in 8 minutes



FLEXVALVE



Monoblock container



Lago system



NORMA-PLUS float valve, acoustic cl. 1. LGA-TUV



100% Made in Italy

STRUCTURE FEATURES

- Anti-corrosion galvanised frame
- Thickness 100 mm

CISTERN FEATURES

- 9 litre one-piece high-density PE container without splice points
- Repairable in case of accidental drilling
- Plaster holder fixing mesh
- Extruded closed-cell PE insulation, anti-condensate and soundproofing with thermal resistance
- FlexValve: discharge valve with silicon gasket. Made of polypropylene with silicone additive (PTE)
- Norma-Plus float valve acoustic class 1 LGA-TUV approved
- Maintenance operations without using tools
- Pneumatisable without the need to replace internal components

DIMENSIONS

S

STANDARD SUPPLY

- Dismountable stop valve 3/8"-3/8" including fitting 1/2"-3/8"
- Set of self-tapping screws for frame fastening
- Telescopic polystyrene insulated exhaust pipe with universal conical clamp, height adjustable up to 100 mm
- Removable drain
- Drain valve
- Norma-Plus float valve
- Protection template to shape perimeter of tiles or plaster
- Protection caps for outlet pipe

IT NEEDS TO BE INTEGRATED WITH DUAL COUNTERPLATE COD. 317010

ON DEMAND

- Dual counter-plate
- Fidia/Itaka/Aurea cover plate
- Sleeve kit Ø40
- Sleeve kit Ø32
- Extension
- Pneu system

S

PACKAGING

CODE	PCS	LxDxH	KG
377319	1	1320x590x150	7,30

ACCESSORIES AND SPARE PARTS

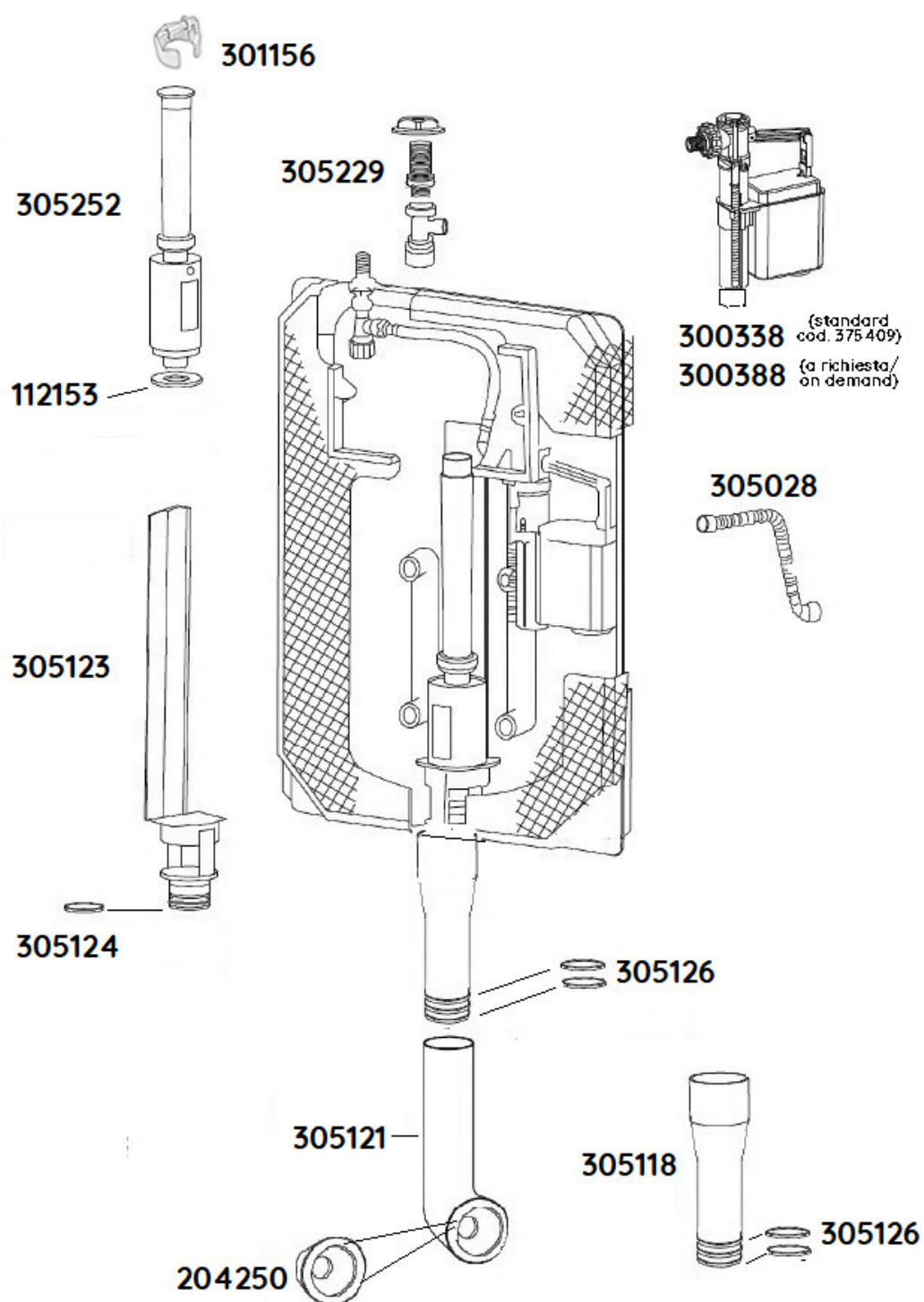

ACCESSORI INCLUSI
INCLUDED



cod 305229



cod 300388



cod 300338*



cod 305121



cod 305123



cod 305252

NON INCLUSI
NOT INCLUDED



cod 317010
controplacca duo - counter plate

Aurea
Fidia
Itaka



Placca comando
Control plate

ACCESSORI A RICHIESTA
ON DEMAND



cod 204006
Ø 40



cod 204001
Ø 32



cod 305118



cod. 400190



cod. 400195



cod. 400194



cod. 400197

ELENCO

CODE	DESCRIPTION
300388	Norma 3/8" float valve for concealed cistern
300338*	Norma-Plus 3/8" float valve for concealed cistern, acoustic class I
305229	Dismountable brass stop valve 3/8"-3/8" including fitting 1/2"-3/8"
305123	Removable drain
305121	Bend pipe with insulation for 9 lt concealed cisterns, 9.0 lines
305252	Discharge valve
400190	Pneu transforming kit with aluminium inspection plate and remote white hand-button
400195	Pneu transforming kit with aluminium inspection plate and remote white plastic leg-button for floor/wall
400194	Pneu transforming kit with aluminium inspection plate and remote inox leg-button
400197	Pneu transforming kit with aluminium inspection plate and remote white hand-button
204006	Sleeve kit Ø40
204001	Sleeve kit Ø32
305118	Extension